

# Wood and Steel Strong-Wall®: Installation Information

Refer to installation information attached to walls included with connection kits or at [www.strongtie.com](http://www.strongtie.com).

## GARAGE FRONTS

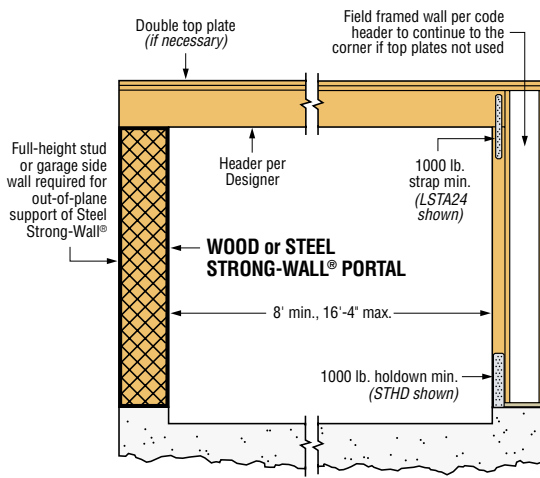

### MINIMUM CONNECTIONS WITH STEEL STRONG-WALL® (NON PORTAL)

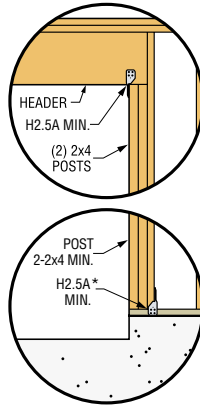

\*Zmax connectors (for example, H2.5AZ) should be used when in contact with some preservative-treated woods. See [www.strongtie.com](http://www.strongtie.com) for the most current information.

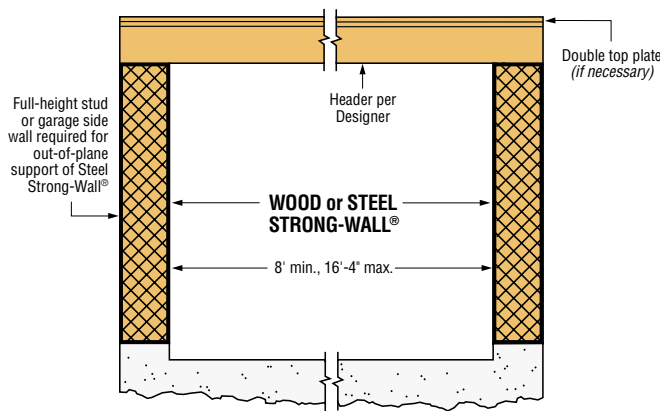

### MINIMUM CONNECTIONS WITH STEEL STRONG-WALL® (NON PORTAL)

LSTA24 min. centered on header splice installed on opposite side of header (not required if top plates used)

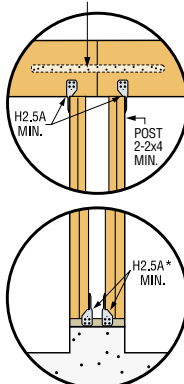
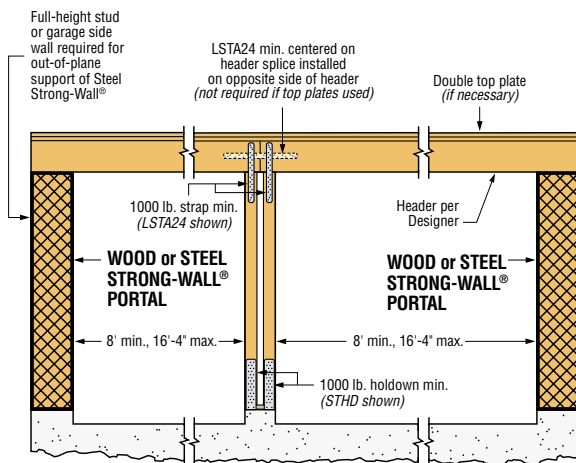

\*Zmax connectors (for example, H2.5AZ) should be used when in contact with some preservative-treated woods. See [www.strongtie.com](http://www.strongtie.com) for the most current information.

## TOP CONNECTIONS – STEEL STRONG-WALL®

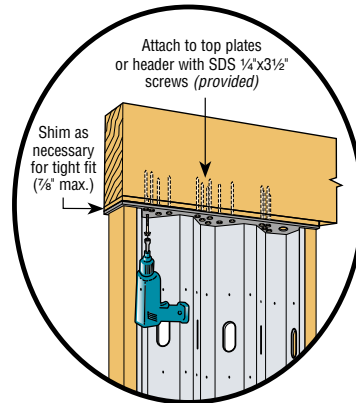

### HEADER CONNECTION

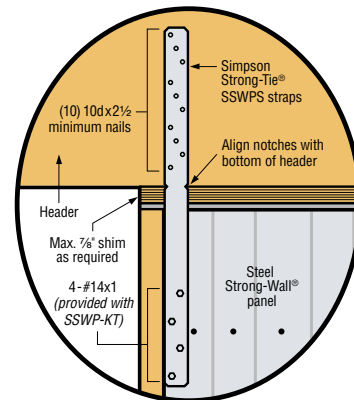

### EXTERIOR VIEW OF GARAGE PORTAL FRAME (When specified with SSWP-KT)

Header by Designer. 2-ply 2x12 min. with 1/2" sheathing between plies or 2-ply 1 3/4"x1 1/8" min. LVL (2-ply LVL shown)

Note: Multi-ply headers may be used with Steel Strong-Wall® panel for wind designs or in seismic design categories A-C (IBC & IRC) only

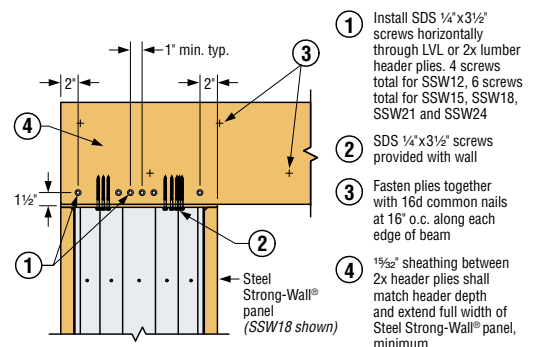
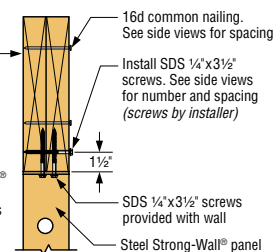

### Side View

### SSW WITH MULTI-PLY HEADER

- 1 Install SDS 1/4"x3 1/2" screws horizontally through LVL or 2x lumber header plies. 4 screws total for SSW12, 6 screws total for SSW15, SSW18, SSW21 and SSW24
- 2 SDS 1/4"x3 1/2" screws provided with wall
- 3 Fasten plies together with 16d common nails at 16" o.c. along each edge of beam
- 4 1/2" sheathing between 2x header plies shall match header depth and extend full width of Steel Strong-Wall® panel, minimum

# Steel Strong-Wall®: Installation Information



## TOP CONNECTIONS

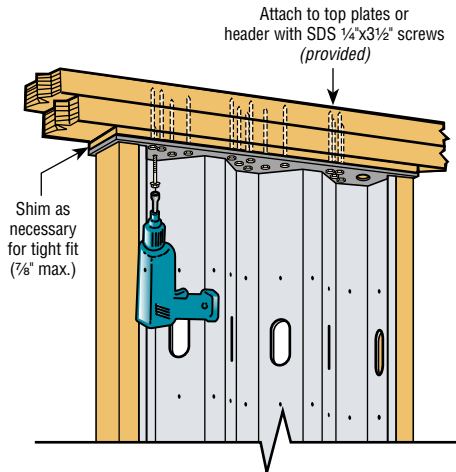

**TOP-PLATE CONNECTION**

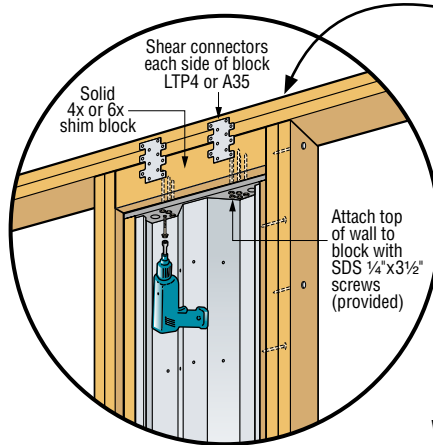

**BALLOON FRAMING TOP-OF-WALL CONNECTION**

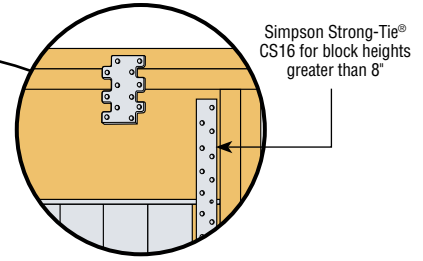

Block Height (H)	CS16 Nailing (0.148 x 1.5" Nails)	
	Into Block	Into SSW Nailer Stud
H ≤ 8"	N/A	N/A
8" < H ≤ 10"	8-10d x 1½"	8-10d x 1½"
10" < H ≤ 12"	10-10d x 1½"	10-10d x 1½"

## WOOD BLOCK TO TOP PLATE CONNECTION

Strong-Wall® Width	Total Connectors	Recommended Connectors
15" Wall	4 (2 Each Side)	Simpson Strong-Tie® LTP4 or A35
18" Wall	4 (2 Each Side)	
21" Wall	6 (3 Each Side)	
24" Wall	6 (3 Each Side)	

## BOTTOM CONNECTIONS

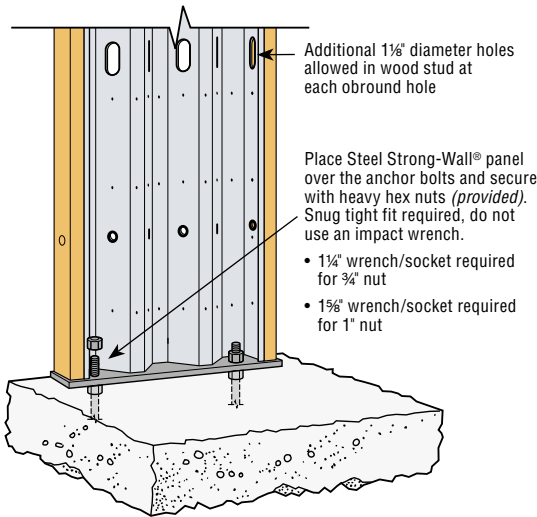

**BASE-PLATE CONNECTION**



**DO NOT** cut wall or enlarge existing holes

Place Steel Strong-Wall® panel over the anchor bolts and secure with heavy hex nuts (provided). Snug tight fit required, do not use an impact wrench.

- 1¼" wrench/socket required for ¾" nut
- 1½" wrench/socket required for 1" nut

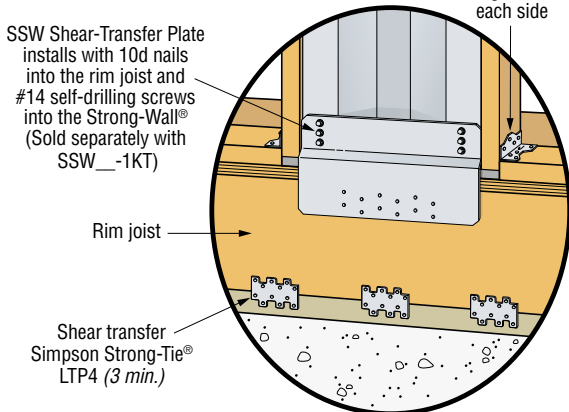

**EXTERIOR VIEW OF SHEAR-TRANSFER PLATE**

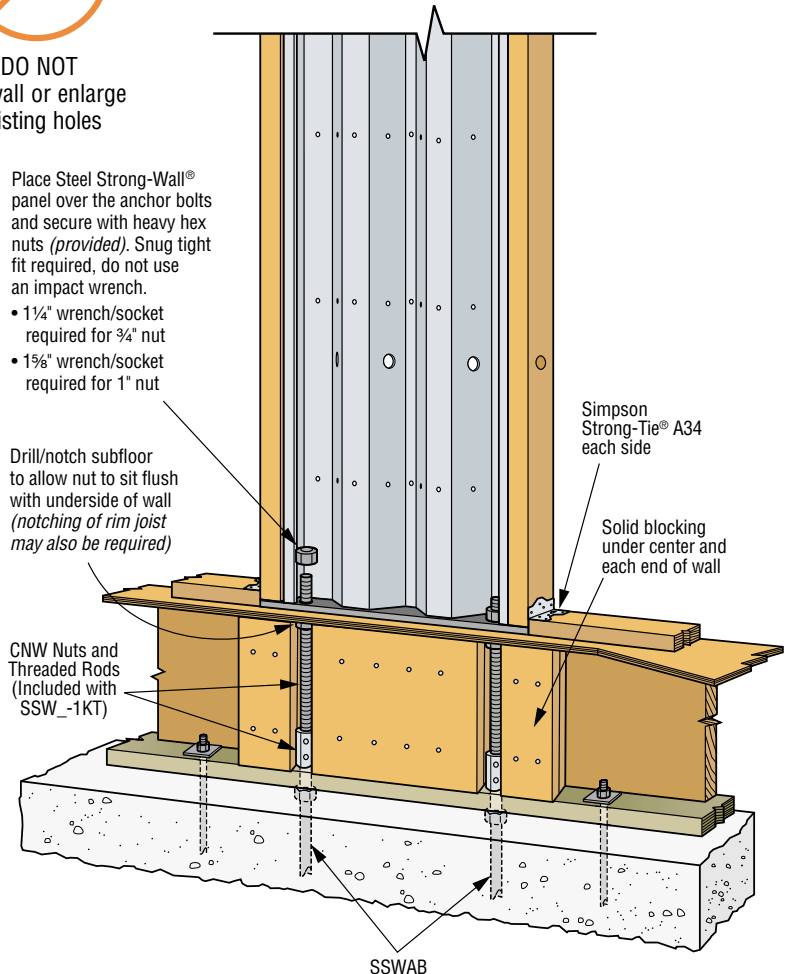

**WOOD FIRST FLOOR**

1. Alternate connectors with equivalent shear capacity may be specified by the Designer.

# Steel Strong-Wall®: Installation Information



## BOTTOM CONNECTIONS

Full height studs with blocking below for balloon framing

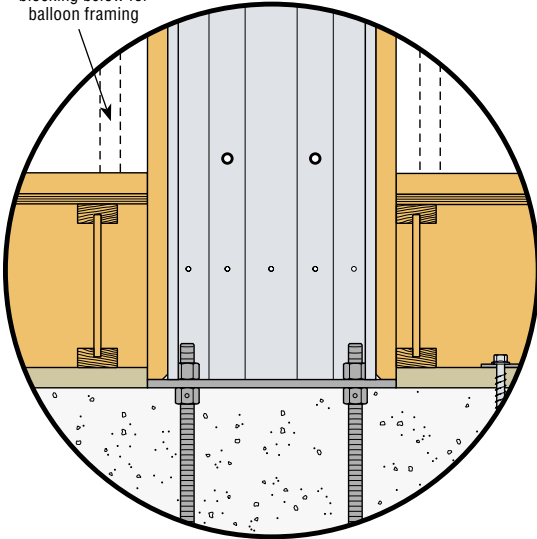

### ALTERNATE 1ST-FLOOR INSTALLATION

Installation for 1st-floor wood-floor system. Specify taller wall model to allow for floor framing.

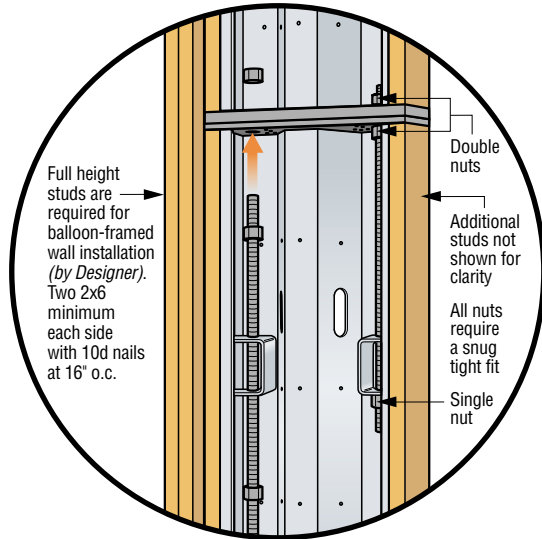

### BALLOON FRAMING STACKED-WALL CONNECTION DETAIL

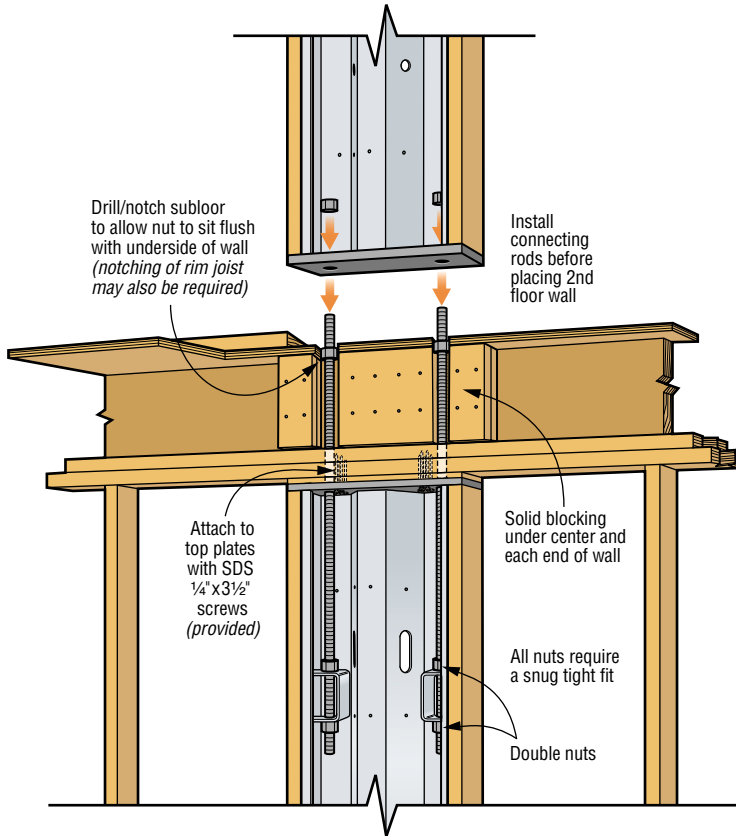

### TWO-STORY STACKED-WALL CONNECTION DETAIL

## SHEAR-TRANSFER PLATE FASTENERS

Strong-Wall Width	Fastener Quantity	
	#14 Screws	10d Nails
15" Wall	4	10
18" Wall	6	12
21" Wall	6	16
24" Wall	7	18

SSW Shear-Transfer Plate installs with 10d nails into the rim joist and #14 self-drilling screws into the Strong-Wall® panel (Sold separately with SSW\_-2KT)

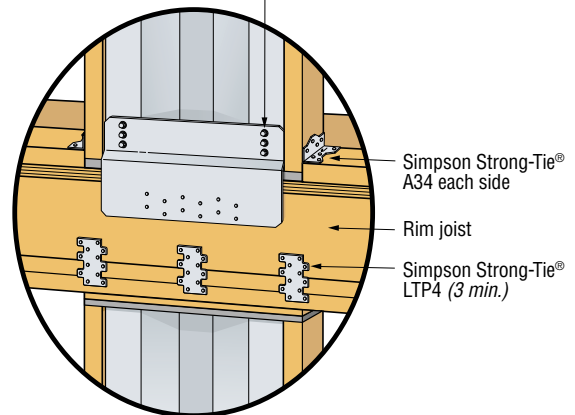

### EXTERIOR VIEW OF SHEAR-TRANSFER PLATE